



**Series 400**  
**Power Ditcher - Offset Cut**  
**Operator and Parts Manual**



## **Limited Warranty**

Remlinger Manufacturing will warrant all products against defects in material and workmanship manufactured and sold by it. Warranty will only be granted after examination by appropriate personnel. This warranty is expressly limited to the replacement or repair of the defective products. This warranty does not obligate Remlinger Manufacturing to cover cost of labor to replace these parts. This warranty is in effect for 1 year after purchase.

**Remlinger Manufacturing warrants its own products only and cannot be responsible for damages to equipment on which it is attached or mounted.**

Under no circumstances will this Limited Warranty cover any parts or components, in the opinion Remlinger Manufacturing, that has been subject to negligent handling, misuse, alteration, an accident, or if repairs have been made with parts other than those obtained from Remlinger Manufacturing.

Parts claimed to be defective must be returned at the Owner's expense and returned to Remlinger Manufacturing for inspection with shipping charges prepaid. Parts found to be defective will be replaced or repaired and returned promptly free of charge.

**For questions or comments about your Remlinger Product contact:**

Remlinger Manufacturing Company Inc.  
16394 U.S. 224  
Kalida, OH 45853

Phone: 1-800-537-7370  
Email: [technicalsupport@remlingermfg.com](mailto:technicalsupport@remlingermfg.com)  
Website: [www.remlingermfg.com](http://www.remlingermfg.com)

**READ THIS MANUAL** carefully to learn how to assembly, adjust, operate and service your Remlinger Power Ditcher properly. Failure to do so could result in personal injury or equipment damage.

**THIS MANUAL SHOULD BE** considered a permanent part of this product and should remain with it at all times for reference.

**ALL REFERENCES** to Right-Hand and Left-Hand are determined by facing the implement or tool from the rear.

**READ AND UNDERSTAND** the Limited Warranty before operating the ditcher. The Limited Warranty is located on the inside front cover.

**Serial Number** for the Power Ditcher is located on the upper Right-Hand side of the drive Housing. The number on the **PFM** metal tag is the ditcher **model number**. The number on the **Remlinger** decal is the **serial number**.

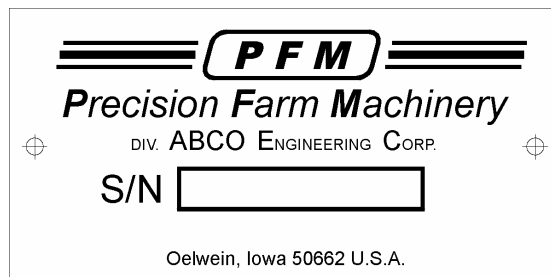

<b>SERIAL NO:</b>
000000000
<b>REMLINGER MFG CO.</b>

**Please complete the Registration Form – located on the last page of this manual.**

**For Your Records**

**Dealer Purchased From**

Name: \_\_\_\_\_

Address: \_\_\_\_\_

City: \_\_\_\_\_ State: \_\_\_\_\_ Zip: \_\_\_\_\_

Date Purchased \_\_\_\_\_

Model No. \_\_\_\_\_ (located on the Right-Hand side of the Drive Housing)

Serial No. \_\_\_\_\_ (located on the Right-Hand side of the Drive Housing)

THIS PAGE LEFT BLANK

# Contents

Identification View .....	1
Checklist .....	2
PRE DELIVERY CHECKLIST .....	2
DELIVERY CHECKLIST .....	2
Safety .....	3
RECOGNIZE SAFETY INFORMATION .....	3
UNDERSTAND SIGNAL WORDS .....	3
FOLLOW SAFETY INSTRUCTIONS .....	3
Safety Cont. ....	4
OPERATE SAFELY .....	4
STAY CLEAR OF ROTATING DRIVE LINES .....	4
LUBRICATE THE DITCHER SAFELY .....	4
Operating .....	5
BREAK-IN .....	5
FIELD OPERATION .....	5
MAINTAINING ROTOR BALANCE .....	5
Lubrication and Maintenance .....	6
SYMBOLS .....	6
Q-D BUSHING TORQUE .....	6
Belt tension setting .....	7
Troubleshooting .....	8
Torque Values .....	9
Storage .....	10
END OF SEASON .....	10
BEGINNING OF SEASON .....	10
Safety Decal Locations .....	11
Offset Power Ditcher Assembly Models 400-40, 400-50 and 400-60 .....	12
Offset Power Ditcher 40000137 B.O.M. Models 400-40, 400-50 and 400-60 .....	13
Offset Ditcher Shank Assembly 40000133 Models 400-40, 400-50 and 400-60 .....	14
Offset Ditcher Colter Assembly 40000101 Models 400-40, 400-50 and 400-60 .....	15
Offset Ditcher Gauge Wheel Assembly 40000047 Models 400-40, 400-50 and 400-60 .....	16
PTO SHAFT ASSEMBLY FOR 1 3/8" - 6 SPLINE SHAFT PART # 11300060 (WEASLER) .....	17
PTO SHAFT ASSEMBLY FOR 1 3/8" - 21 SPLINE SHAFT PART # 11300061 (WEASLER) .....	18
PTO SHAFT ASSEMBLY FOR 1 3/4" - 20 SPLINE SHAFT PART # 11300062 (WEASLER) .....	19

THIS PAGE LEFT BLANK

# Identification View

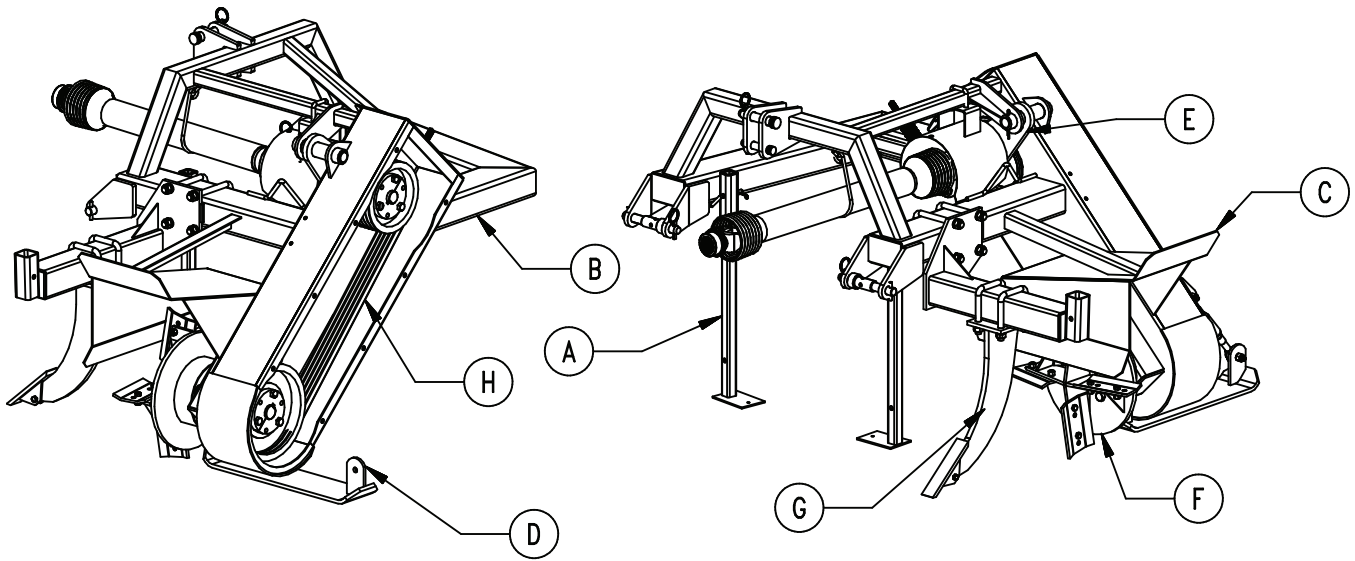

A PARKING STAND  
B FRAME  
C DISCHARGE CHUTE  
D DEPTH SKID

E BEARING SHAFT ASSEMBLY  
F KNIFE ROTOR ASSEMBLY  
G RIPPER SHANK ASSEMBLY (OPTIONAL)  
H BELT & SHEAVE DRIVE

# Checklist

## PREDELIVERY CHECKLIST

After the ditcher has been completely assembled, inspect it to be sure it is good running order before delivering it to the customer. Check each item when found satisfactory or after making the necessary adjustments.

- ☐ Ditcher has been assembled properly.
- ☐ All grease fittings have been lubricated.
- ☐ Lubricate all lubrication points; be sure all fittings are taking grease and check all lubrication seals for leakage.
- ☐ Check drive belt tension and adjust, if necessary.

Date Set Up \_\_\_\_\_

- ☐ Check tightness of all external nuts and bolts. Pay particular attention to those securing the blades.
- ☐ Check that all moving parts are working freely.
- ☐ Connect PTO, check operation of PTO, sheave, belt drive and roter. Watch for any signs of faulty operation, vibration or unusual sounds. After a period of operation, shut off tractor engine. Check for loose bolts.
- ☐ Clean the ditcher and touch up any places where the paint is nicked or scratched. Be sure all decals are properly applied and undamaged.

## DELIVERY CHECKLIST

The following check list is a reminder of very important information which should be conveyed directly to the customer at the time the ditcher is delivered. Check off each item as it is fully explained.

- ☐ Advise the customer that the life expectancy of this or any other machine depends on regular lubrication as described in the operator's manual.
- ☐ Give the operator's manual to your customer and explain all operating adjustments and lubrication.
- ☐ Explain the importance of safe and proper operation of the machine. Point out decals warning the operator of the dangers of unsafe operating procedures and conditions.

Date Delivered \_\_\_\_\_

Signature of Set-up Technician \_\_\_\_\_

- ☐ Advise the customer that he must check the torque of nuts and bolts after the first 4 hours of operation.
- ☐ Tell the customer to record the serial number of this ditcher in the space provided on page iii of this manual.
- ☐ Complete Delivery and Warranty Registration forms, listing serial number of machine.
- ☐ Explain Warranty. Have dealer and customer sign form.

Signature of Set-up Technician \_\_\_\_\_



# Safety

## RECOGNIZE SAFETY INFORMATION

This is the safety-alert symbol. When you see this symbol on your machine or in this manual, be alert to the potential for personal injury.

Follow recommended precautions and safe operating practices.



## UNDERSTAND SIGNAL WORDS

**DANGER:** Indicates an imminently hazardous situation that if not avoided, will result in death or serious injury. This signal word is to be limited to most extreme situations, typically for machine components that, for functional purposes, cannot be guarded.

**WARNING:** Indicates a potentially hazardous situation that, if not avoided could result in death or serious injury, and includes hazards that are exposed when guards are removed. It may also be used to alert against unsafe practices.

**CAUTION:** Indicates a potentially hazardous situation that, if not avoided, may result in minor or moderate injury. It may also be used to alert against unsafe practices



## FOLLOW SAFETY INSTRUCTIONS

Carefully read all safety messages in this manual and on your machine safety signs. Keep safety signs in good condition. Replace missing or damaged safety signs. Be sure new equipment components and repair parts include the current safety signs. Replacement safety signs are available from your P F M dealer.

Learn how to operate the machine and how to use controls properly. Do not let anyone operate without instruction.

Keep your machine in proper working condition. Unauthorized modifications to the machine may impair the function and/or safety and affect machine life.

If you do not understand any part of this manual and need assistance, contact your P F M dealer.



# Safety Cont.

## OPERATE SAFELY

To avoid bodily injury, keep all power drive safety shields in place.

Operate ditcher with 540 or 1000 rpm tractor.

Should excessive vibration occur, disengage tractor PTO shaft immediately.

Be sure rotor has stopped completely before checking blades.

Always replace broken, worn or missing blades.

Never ride, or permit others to ride, on the drawbar of the tractor or on the ditcher.

## STAY CLEAR OF ROTATING DRIVE LINES

Entanglement in rotating drive line can cause serious injury or death.

Keep tractor master shield and drive line shields in place at all times. Make sure rotating shields turn freely.

Wear close fitting clothing. Stop the engine and be sure PTO drive line is stopped before making adjustments, connections, or cleaning out PTO driven equipment.



## LUBRICATE THE DITCHER SAFELY

Do not clean, lubricate, or adjust the ditcher while it is in motion.

Before servicing or adjusting the ditcher, or removing material from it, always:

1. Disengage the power.
2. Shut off the engine.
3. Wait until ditcher rotor has stopped rotating.

# Operating

## BREAK-IN

Before starting the ditcher, lubricate the machine. See Lubrication and Maintenance Section.

**CAUTION:** Never operate the ditcher until the power shaft and other safety shields are in place and secured, Tighten all nuts and check cotter pins to see they are properly installed.



## FIELD OPERATION

**IMPORTANT:** The constant striking of rotor blades and sudden impacts may cause excessive shear pin breakage. Reduce ditch depth or tractor speed.

Under most conditions, the tractor can be operated at 5 to 11 km/h (3 to 7 mph) without causing undue wear on the ditcher. Avoid excessive speeds. Reasonable speeds result in higher productivity.

Various ditching conditions require different ground speeds. Best results will be obtained by running the tractor at the travel speed that will meet field conditions or the speed where the smoothest ditching action results.

**IMPORTANT:** When operating the ditcher always check the cutting depth so rotor will spread soil evenly and consistent.

**IMPORTANT:** Always operate the ditcher with the tractor at recommended speed to obtain 540 or 1000 rpm on the tractor PTO shaft.

Operating the tractor at less than recommended PTO rpm will reduce the blade rotor speed and result in improper ditching. Where difficult conditions make it necessary to slow down the ground speed of the tractor, shift to a lower gear, thus keeping the engine at its rated speed.

Reduce tractor RPM and disengage PTO when raising tractor 3 point hitch. PTO angle should never exceed 20 degrees while engaged.

**IMPORTANT:** Do not engage PTO with engine running at high speed. Doing so may cause undue wear or possible drive line and/or belt damage.

## MAINTAINING ROTOR BALANCE

The rotor on your power ditcher is dynamically balanced and must be maintained in balance throughout the life of the machine.

**CAUTION:** Should excessive vibration occur, disengage the tractor PTO shaft immediately ! Shut off the tractor and determine the cause of problem. Correct the problem before operating again. See Service Section.



# Lubrication and Maintenance

## SYMBOLS



Lubricate with Multi-Purpose lubricant or an equivalent SAE multipurpose type grease at hourly intervals indicated by the symbols.

**CAUTION:** Do not clean, lubricate, or adjust your machine while it is in motion.



Clean grease fittings before using grease gun. Replace any lost or broken fittings immediately.

The application of grease in bearing area is very critical. Grease approximately four pumps every 50 hours. **DO NOT OVER GREASE**

### Q-D "E" BUSHING TORQUE

Tighten bushing bolts to 60 ft. lbs.

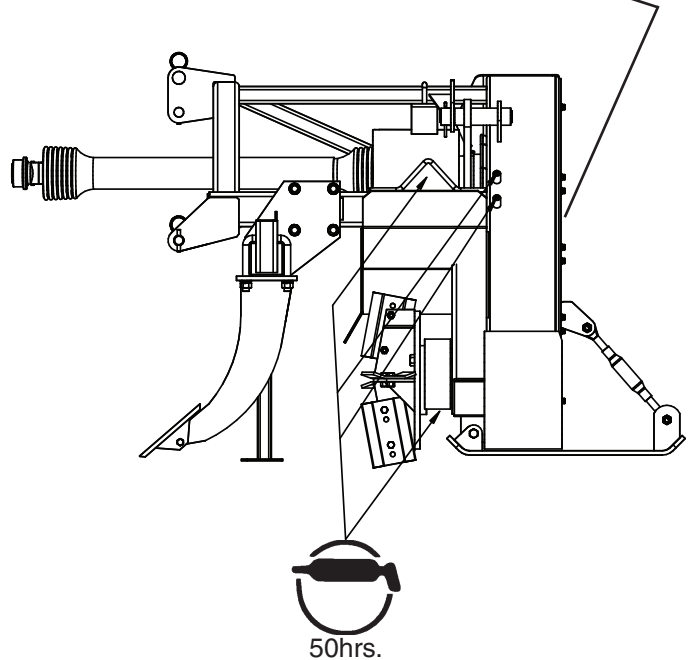

Grease telescoping shaft and universal joints every 50 hours.

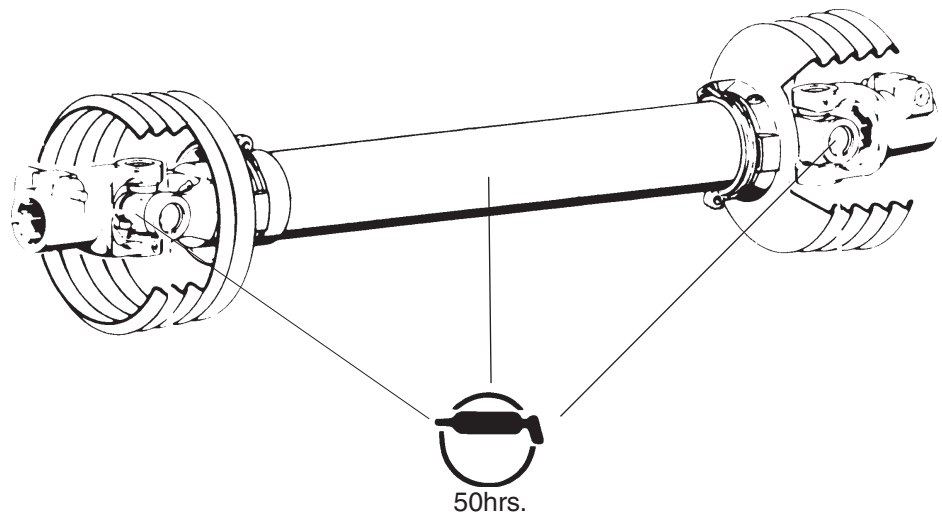

# Belt Tension Setting

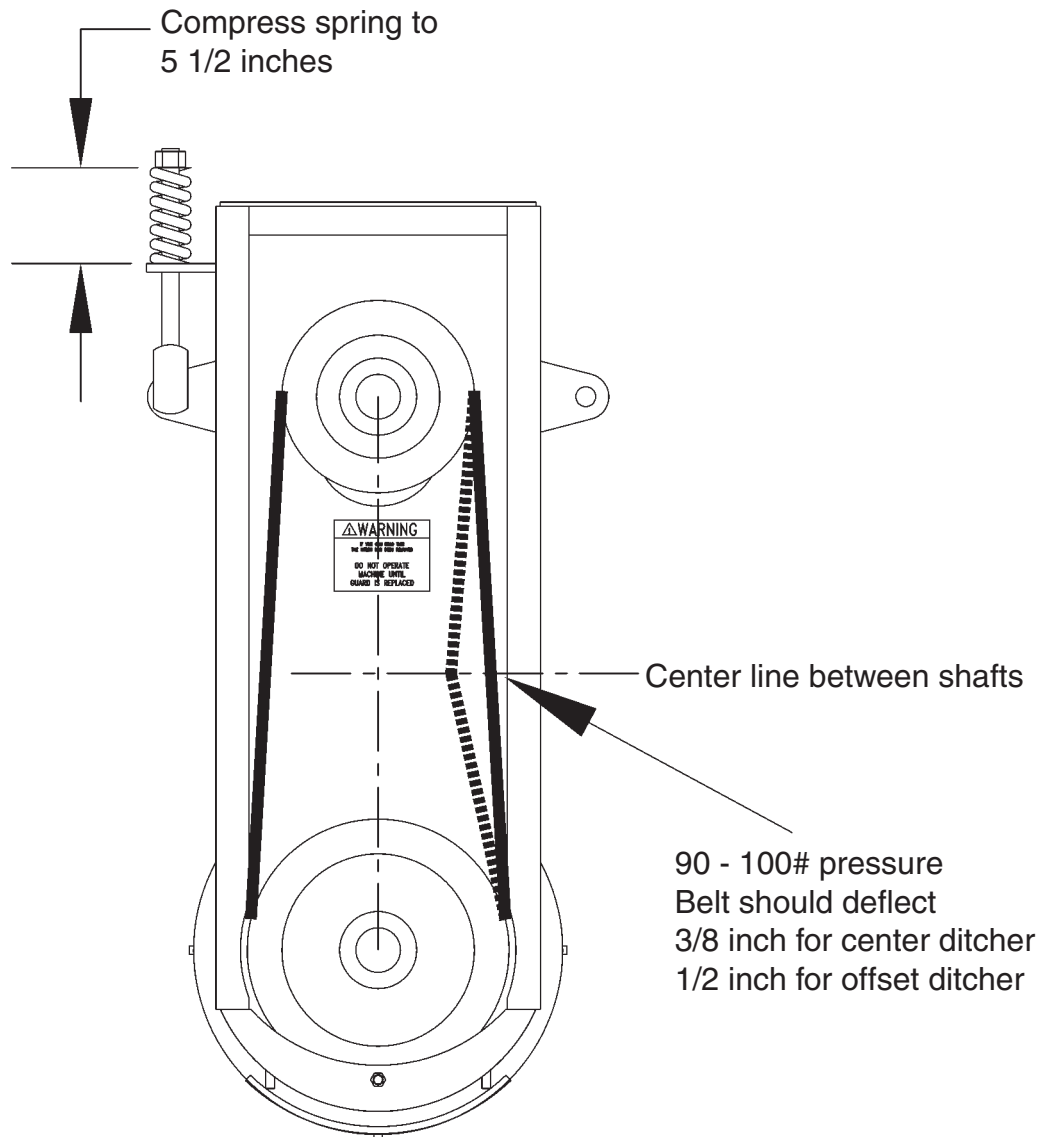











# Troubleshooting

Symptom	Problem	Solution
Ditch too shallow	Adjustment	Lower 3 pt on tractor Retract 3 <sup>rd</sup> link on tractor 3 point Adjust slide shoe up
Ditch too deep	Adjustment	Raise 3 pt on tractor Extend 3 <sup>rd</sup> link on tractor 3 point Adjust slide shoe down
Non uniform ditching	Improper tractor speed or PTO RPM	Reduce tractor ground speed Run PTO at proper RPM
Discharging material not consistent	Dirt buildup on discharge spout Ditching too deep in one pass	Clean spout Adjust machine and make two passes
Leaving ridge on discharge side of blade rotor	Improper tractor ground speed Ditching too deep	Operate tractor at proper ground speed Adjust machine and make two passes
Excessive vibration	Loss of rotor knife Rotor deformation Rotor bearing worn out	Install new knife Straighten the rotor or replace it Replace bearing
Belt breakage	Incorrect tension Misalignment between sheaves Residue in the rotor drive	Adjust belt for proper tension Align sheaves Clean and replace shield
Belt slippage	Incorrect tension Improper ground speed Ditching too deep in one pass	Adjust belt for proper tension Reduce ground speed Make two passes

# Torque Values

## UNIFIED INCH BOLT AND CAP SCREW TORQUE VALUES

SAE Grade and Head Markings	NO MARK	1 or 2 <sup>b</sup> 	5 	5.1 	5.2 	8 	8.2 
		2 	5 			8 	

Size	Grade 1				Grade 2 **				Grade 5, 5.1, or 5.2				Grade 8 or 8.2			
	Lubricated *		Dry *		Lubricated *		Dry *		Lubricated *		Dry *		Lubricated *		Dry *	
	N.m	lb-ft	N.m	lb-ft	N.m	lb-ft	N.m	lb-ft	N.m	lb-ft	N.m	lb-ft	N.m	lb-ft	N.m	lb-ft
1/4	3.7	2.8	4.7	3.5	6	4.5	7.5	5.5	9.5	7	12	9	13.5	10	17	12.5
5/16	7.7	5.5	10	7	12	9	15	11	20	15	25	18	28	21	35	26
3/8	14	10	17	13	22	16	27	20	35	26	44	33	50	36	63	46
7/16	22	16	28	20	35	26	44	32	55	41	70	52	80	58	100	75
1/2	33	25	42	31	53	39	67	50	85	63	110	80	120	90	150	115
9/16	48	36	60	45	75	56	95	70	125	90	155	115	175	130	225	160
5/8	67	50	85	62	105	78	135	100	170	125	215	160	215	160	300	225
3/4	120	87	150	110	190	140	240	175	300	225	375	280	425	310	550	400
7/8	190	140	240	175	190	140	240	175	490	360	625	450	700	500	875	650
1	290	210	360	270	290	210	360	270	725	540	925	675	1050	750	1300	975
1-1/8	470	300	510	375	470	300	510	375	900	675	1150	850	1450	1075	1850	1350
1-1/4	570	725	725	530	570	425	725	530	1300	950	1650	1200	2050	1500	2600	1950

DO NOT use these values if a different torque value or tightening procedure is given for a specific application. Torque values listed are for general use only. Check tightness of fasteners periodically.

Shear bolts are designed to fail under predetermined loads. Always replace shear bolts with identical grade.

Fasteners should be replaced with the same or higher grade. If higher grade fasteners are used, these should only be tightened to the strength of the original.

Make sure fasteners threads are clean and that you properly start thread engagement. This will prevent them from failing when tightening.

Tighten plastic insert or crimped steel-type lock nut to approximately 50 percent of the dry torque shown in the chart, applied to the nut, not to the bolt head. Tighten toothed or serrated-type lock nuts to the full torque value.

<sup>a</sup> "Lubricated" means coated with a lubricant such as engine oil, or fasteners with phosphate and oil coatings. "Dry" means plain or zinc plated without any lubrication.

<sup>b</sup> Grade 2 applies for hex cap screws (not hex bolts) up to 152 mm (6-in.) long. Grade 1 applies for hex cap screws over 152 mm (6-in.) long, and for all other types of bolts and screws of any length.

# Storage

## END OF SEASON

1. Shelter the power ditcher in a dry place.
2. Clean the power ditcher thoroughly inside and out. Trash and dirt will draw moisture and cause rust.
3. Thoroughly lubricate the machine according to the Lubrication Section.
4. Paint all parts from which the paint has been worn.
5. List the replacement parts that will be needed and order them early. The dealer at this time can expedite delivery of parts and install them during slack periods avoiding delays next season.

## BEGINNING OF SEASON

1. Lubricate complete machine; this will force any collected moisture out of the bearings (see Lubrication Section).
2. Tighten all loose bolts, nuts and set screws.
3. Replace blades if worn.
4. Check belt adjustment and belt guides
5. Review your operator's manual.



## Safety Decal Locations

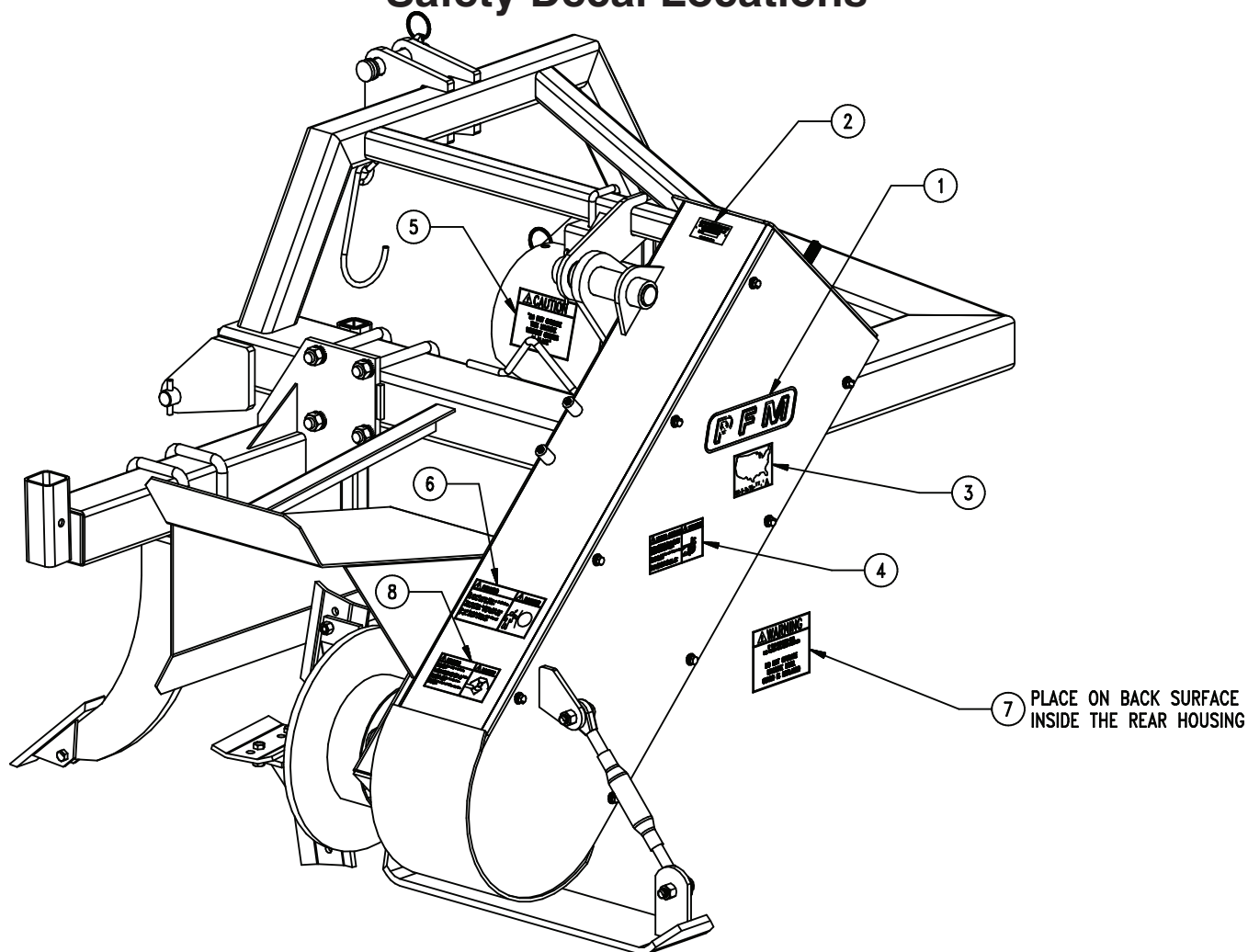

ITEM	PART#	DESCRIPTION	QTY
1	12400012	PFM DECAL- 2 3/4 X 10	1
2	11600016	SERIAL NO. PLATE	1
3	O0164	DECAL- MADE IN U.S.A.	1
4	O0175	WARNING- MOVING PARTS BELT	1
5	O0167	WARNING- DO NOT OPERATE WITHOUT GUARD	1
6	O0192	DANGER- THROWN OBJECT HAZARD	1
7	O0167.5	WARNING- GUARD HAS BEEN REMOVED	1
8	O0191	DANGER- ROTATING BLADE HAZARD	2

# OFFSET POWER DITCHER ASSEMBLY 40000137

## MODELS 400-40, 400-50 AND 400-60

SERIAL # 400-490 to 400-499 and 400-631 to 400-645

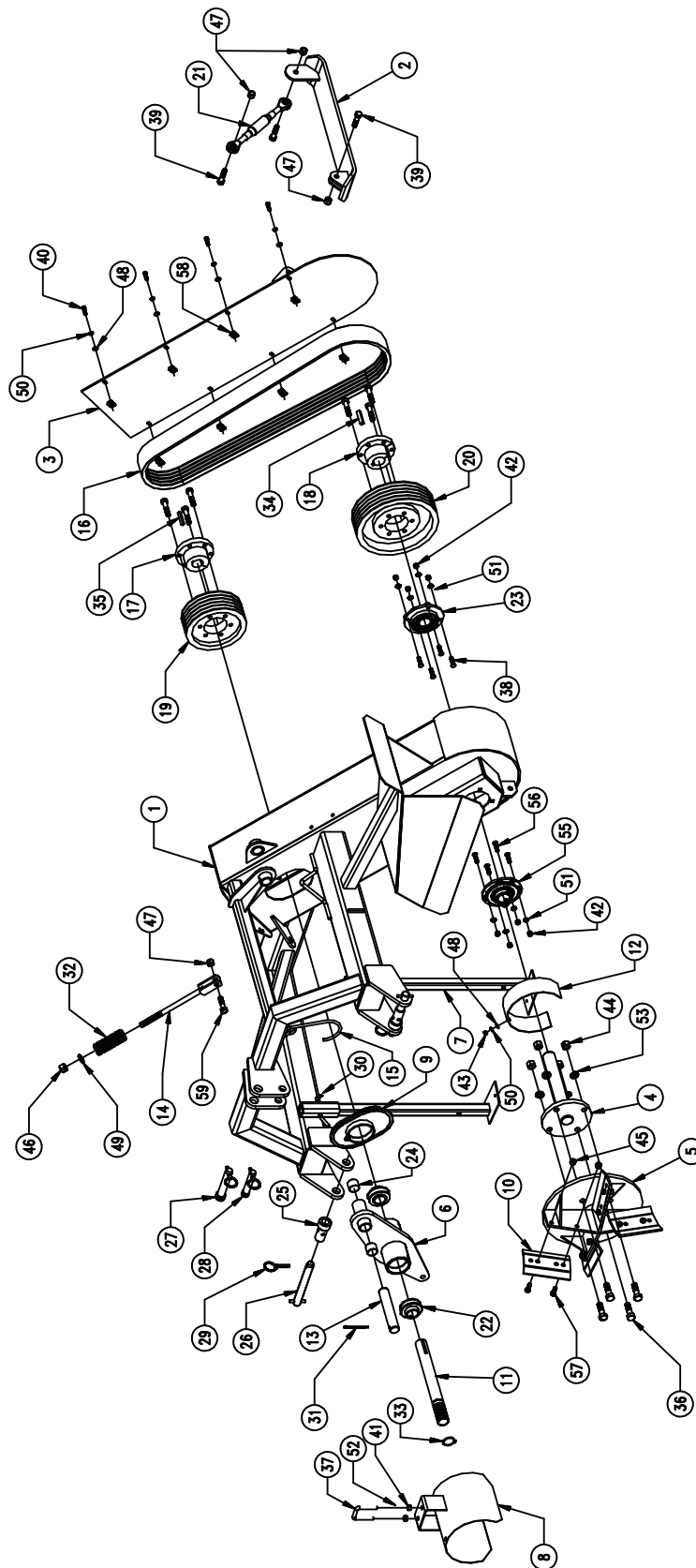

# OFFSET POWER DITCHER 40000137 B.O.M.

## MODELS 400-40, 400-50 AND 400-60

SERIAL # 400-490 to 400-499 and 400-631 to 400-645

ITEM	PART#	DESCRIPTION	QTY	ITEM	PART#	DESCRIPTION	QTY
1	40000127	OFFSET DITCHER FRAME	1	31	10400121	COTTER KEY 1/4 X 3	1
2	40000121	SKID	1	32	10800011	COMPRESSION SPRING - 6"	1
3	40000128	HOUSING COVER	1	33	10400013	RETAINING RING 1 3/4"	1
4	40000123	ROTOR SHAFT	1	34	10400089	KEY 1/2 SQ X 2 1/2	1
5	40000026	KNIFE ROTOR	1	35	10400083	KEY 3/8 SQ X 2 1/2	1
6	40000132	BEARING SHAFT SUPPORT	1	36	F0172.5	HCS 3/4-10 NC X 2 1/2 GR5	4
7	40000023	STAND	2	37	10000201	U-BOLT 1/2-13 NC X 2 X 3	1
8	40000131	P.T.O. GUARD	1	38	10000258.20	CRRG BOLT 7/16-14 NC X 2	4
9	40000094	SHIELD & SEAL ASSEMBLY	1	39	F0157	HCS 5/8-11 NC X 2 1/2 GR5	4
10	11600010	ROTOR BLADE	4	40	F0111.2	HCS 3/8-16 NC X 1 1/4 GR5	8
11	40000024	SPLINE SHAFT 1 3/4 - 20	1	41	10100016	HEX NUT 1/2 NC	2
12	40000130	ROTOR SHIELD	1	42	F0302.7	HEX NUT 7/16 NC	8
13	40000041	PIN 1 1/2" DIA.	1	43	F0302	HEX NUT 3/8 NC	1
14	40000124	TENSIONING BOLT	1	44	10100019	HEX NUT 3/4 NC	4
15	40000083	P.T.O. SUPPORT	1	45	F0303.1	HEX NYLOCK NUT 1/2 NC	8
16	11800022	5/5VX1040 BANDED BELT	1	46	F0306.4	HEX NYLOCK NUT 3/4 NC	1
17	10900010	BUSHING 1 3/4" TYPE 'E'	1	47	10100114	HEX NYLOCK NUT 5/8 NC	4
18	10900034	BUSHING 1 15/16" TYPE 'E'	1	48	F0402	FLAT WASHER 3/8	9
19	10700016	SHEAVE 5/5V9.75E	1	49	F0405	FLAT WASHER 3/4	1
20	10700017	SHEAVE 5/5V13.20E	1	50	F0422	LOCK WASHER 3/8	9
21	12200018	SCREW JACK	1	51	F0450	STAR WASHER 7/16	8
22	10500013	BEARING INSERT 1 3/4"	2	52	F0423	LOCK WASHER 1/2	2
23	10500044	BRNG 1 15/16" PLT FLNG	1	53	F0425	LOCK WASHER 3/4	4
24	10900039	BUSHING 1 1/2" ID	2	54	10500050	BRG. 1 15/16" SPH. ROLLER	1
25	10900026	ADAPTER BUSHING (PAIR)	1	55	10000258	CRRG BOLT 7/16-14 NC X 1 1/2	4
26	10400033	LOWER 3-POINT PIN	2	56	10800011	HCS 1/2-13 NC X 1 1/4 GR5	8
27	10400034	TOP LINK PIN 1 1/4" DIA.	1		10100097	NUT 3/8-16 NC U-STYLE	8
28	10400035	TOP LINK PIN 1" DIA.	1		40000138	COVER GASKET - 124"	1
29	10400032	LYNCH PIN 7/16 X 1 1/2	4		11100041	TOP GREASE TUBE 13"	1
30	10400040	HITCH PIN W/CLIP 1/2 X 3	2		11100062	BOTTOM GREASE TUBE 22.5"	1

# **OFFSET RIPPER SHANK ASSEMBLY 40000133** **MODELS 400-40, 400-50 AND 400-60**

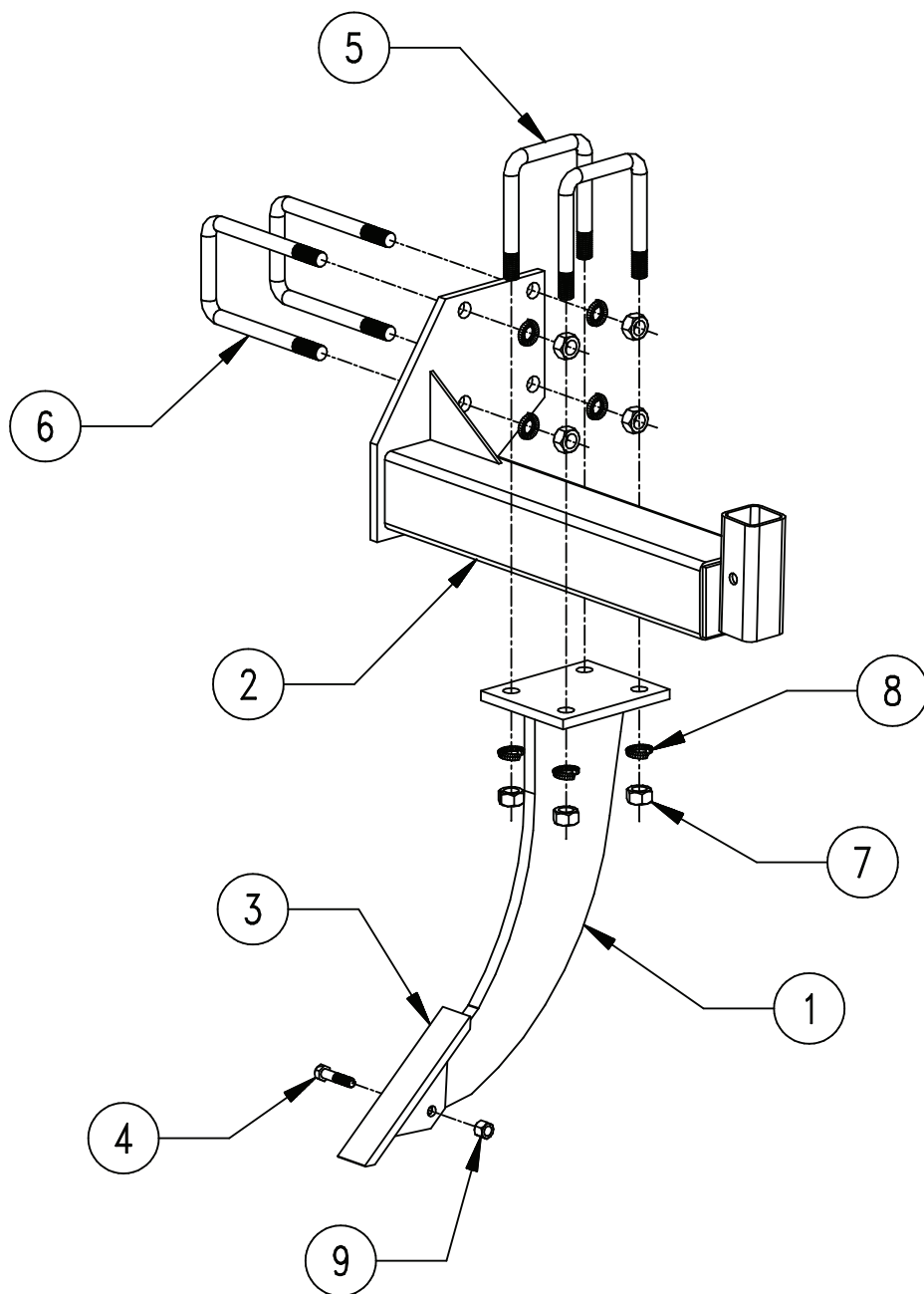

ITEM	PART#	DESCRIPTION	QTY
1	40000014	SHANK WELD	1
2	40000129	OFFSET TOOL BAR	1
3	40000029	RIPPER POINT	1
4	10000074	HCS 1/2-13 NC X 2 GR5	1
5	10000203	U-BOLT 3/4 X 4 1/8 X 5 3/4	2

ITEM	PART#	DESCRIPTION	QTY
6	10000202	U-BOLT 3/4 NC X 4 1/8 X 7 3/4	2
7	10100019	HEX NUT 3/4 NC	8
8	10200049	LOCK WASHER 3/4	8
9	10100112	HEX NYLOCK NUT 1/2 NC	1

# OFFSET DITCHER COLTER ASSEMBLY 40000101

## MODELS 400-40, 400-50 AND 400-60

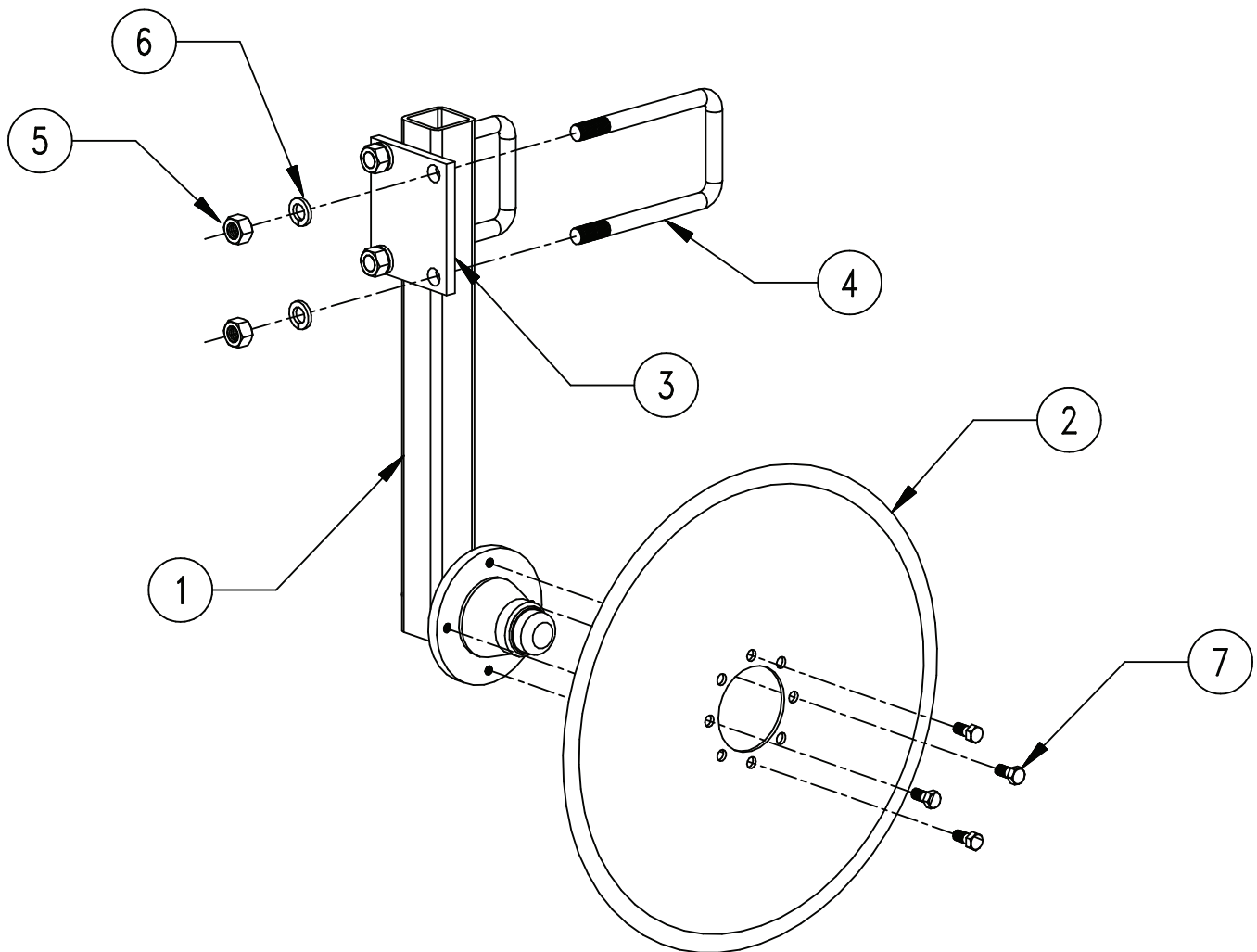

NOTE: TOOL BAR SHOWN IN  
RIPPER SHANK ASSEMBLY REQUIRED

ITEM	PART#	DESCRIPTION	QTY
1	40000102	HUB & LEG ASSEMBLY	1
2	11600016	BLADE - 22" DIA.	1
3	40000104	MOUNTING PLATE	1
4	10000202	U-BOLT 3/4 X 4 1/8 X 7 3/4	2

ITEM	PART#	DESCRIPTION	QTY
5	10100019	HEX NUT 3/4 NC	4
6	10200049	LOCK WASHER 3/4	4
7	10000275	WHEEL BOLT 1/2-20 NF X 3/4	4

# OFFSET DITCHER GAUGE WHEEL ASSEMBLY 40000047

## MODELS 400-40, 400-50 AND 400-60

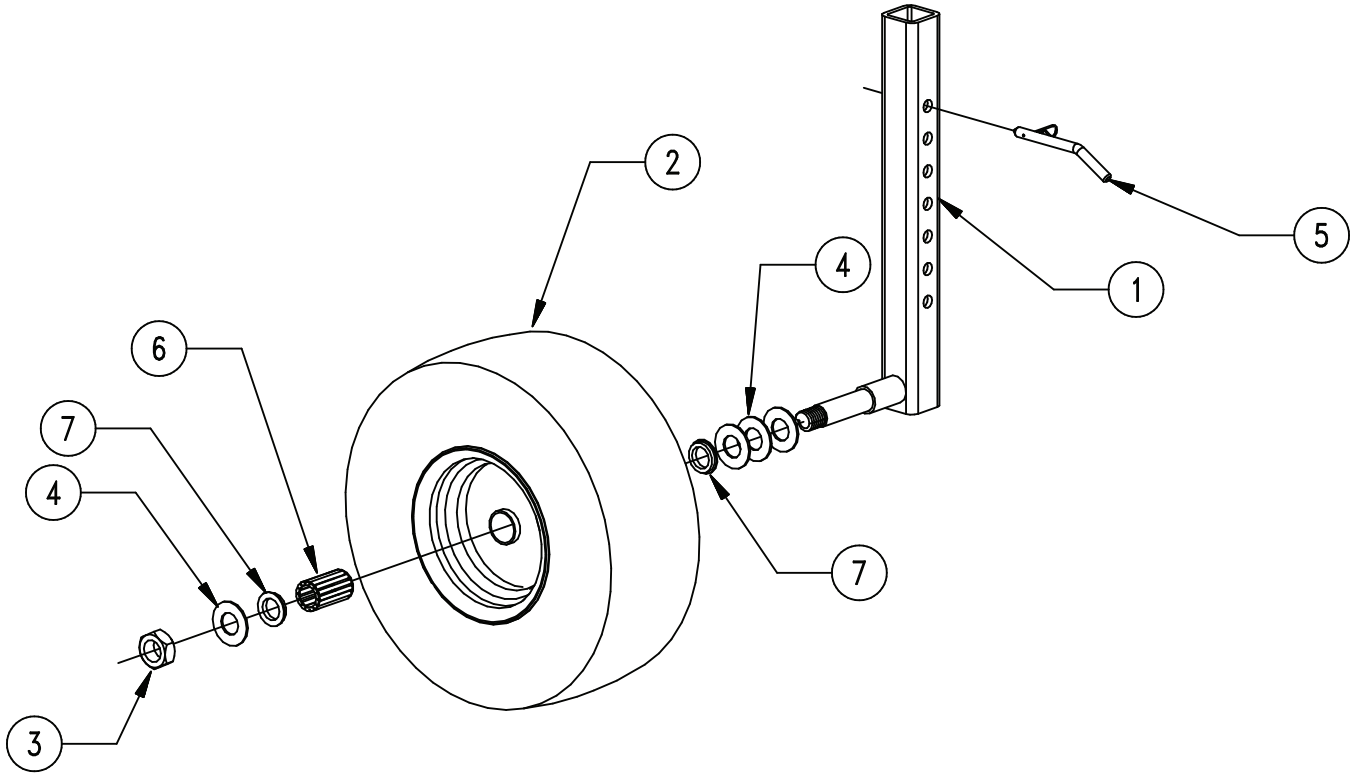

NOTE: TOOL BAR SHOWN IN  
RIPPER SHANK ASSEMBLY REQUIRED

ITEM	PART#	DESCRIPTION	QTY
1	40000045	WHEEL LEG WELD	1
2	11500013	WHEEL & TIRE ASSM.	1
3	10100095	THIN HEX NYLOCK NUT 1-8 NC	1
4	10200033	MACHINERY WASHER 1"ID X 14 GA	4
5	10400040	BENT HITCH PIN	1
6	10500053	ROLLER BEARING 1" OPEN CAGE	1
7	10500054	BEARING RETAINER	2

# WEASLER PTO ASSEMBLY

PART# 11300060

1 3/8" - 6 SPLINE 540 RPM

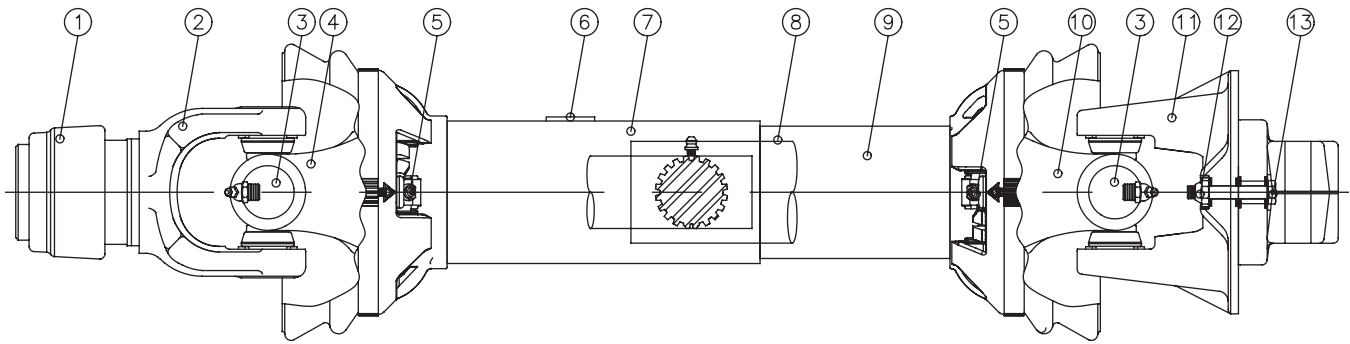

ITEM	PFM#	QTY	TECHNICAL DATA	DESCRIPTION
1	11300081	1	26-15120	AUTO-LOK REPAIR KIT 6 OR 21 SPLINE
2	11300065	1	44011-1006	YOKE ASSEMBLY 1-3/8 6 SPLINE
3	11300064	2	03-10089	CROSS & BEARING KIT
4	11300079	1	99-22532	YOKE & SPLINE SHAFT MALE
5	11300088	2	19-15121	GUARD LOCK REPAIR KIT
6	11300086	1	13-10021	SAFETY SIGN OUTER GUARD
7	11300084	1	97-22532	OUTER GUARD
8	11300085	1	96-22532	INNER GUARD
9	11300087	1	13-10022	SAFETY SIGN INNER GUARD
10	11300080	1	98-22532	YOKE & SPLINE TUBE FEMALE
11	11300063	1	40-20021	BALL SHEAR ASSEMBLY
12	11300069	1	11-10044	LOCK NUT
13	11300068	1	11-10470	SHEAR BOLT
14	11300083	*	90-22532	GUARD SET OUTER + INNER
15	11300071	*	93-22756	HALF SHAFT MALE W/ SHIELD
16	11300072	*	95-22756	HALF SHAFT MALE W/O SHIELD
17	11300077	*	92-22532	HALF SHAFT FEMALE W/ SHIELD
18	11300078	*	94-22532	HALF SHAFT FEMALE W/O SHIELD

# WEASLER PTO ASSEMBLY

## PART# 11300061

### 1 3/8" - 21 SPLINE 1000 RPM

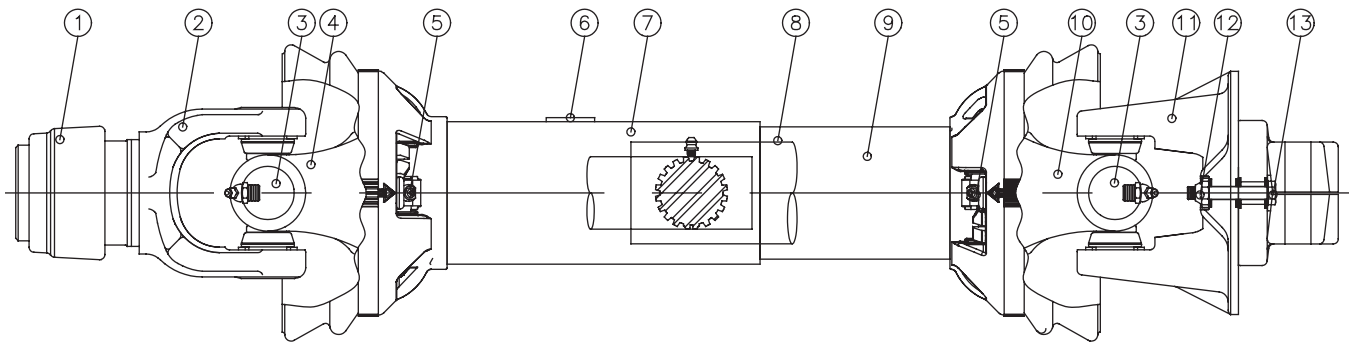

ITEM	PFM#	QTY	TECHNICAL DATA	DESCRIPTION
1	11300081	1	26-15120	AUTO-LOK REPAIR KIT 6 OR 21 SPLINE
2	11300066	1	44011-1007	YOKE ASSEMBLY 1-3/8 21 SPLINE
3	11300064	2	03-10089	CROSS & BEARING KIT
4	11300079	1	99-22532	YOKE & SPLINE SHAFT MALE
5	11300088	2	19-15121	GUARD LOCK REPAIR KIT
6	11300086	1	13-10021	SAFETY SIGN OUTER GUARD
7	11300084	1	97-22532	OUTER GUARD
8	11300085	1	96-22532	INNER GUARD
9	11300087	1	13-10022	SAFETY SIGN INNER GUARD
10	11300080	1	98-22532	YOKE & SPLINE TUBE FEMALE
11	11300063	1	40-20021	BALL SHEAR ASSEMBLY
12	11300069	1	11-10044	LOCK NUT
13	11300068	1	11-10470	SHEAR BOLT
14	11300083	*	90-22532	GUARD SET OUTER + INNER
15	11300073	*	93-22757	HALF SHAFT MALE W/ SHIELD
16	11300074	*	95-22757	HALF SHAFT MALE W/O SHIELD
17	11300077	*	92-22532	HALF SHAFT FEMALE W/ SHIELD
18	11300078	*	94-22532	HALF SHAFT FEMALE W/O SHIELD



# WEASLER PTO ASSEMBLY

PART# 11300062

1 3/4" - 20 SPLINE 1000 RPM

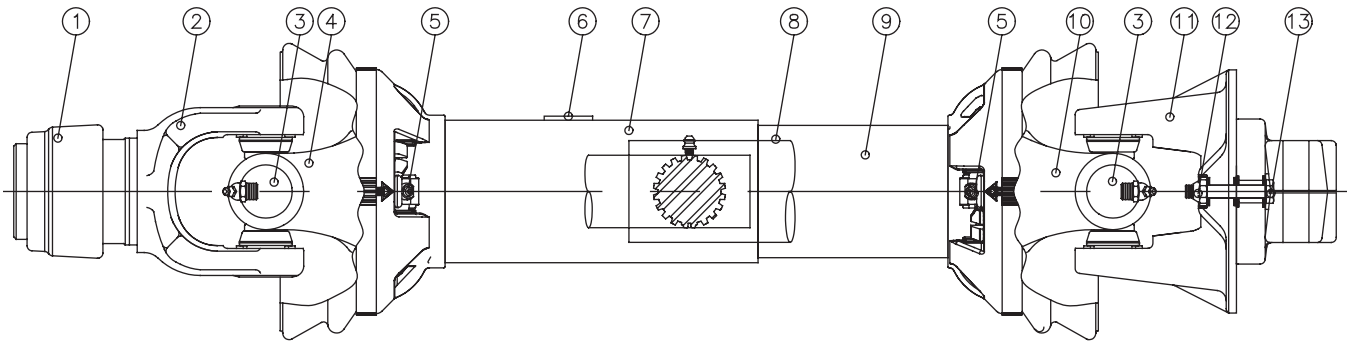

ITEM	PFM#	QTY	TECHNICAL DATA	DESCRIPTION
1	11300082	1	26-13387	AUTO-LOK REPAIR KIT 20 SPLINE
2	11300067	1	44041-1141	YOKE ASSEMBLY 1-3/4 20 SPLINE
3	11300064	2	03-10089	CROSS & BEARING KIT
4	11300079	1	99-22532	YOKE & SPLINE SHAFT MALE
5	11300088	2	19-15121	GUARD LOCK REPAIR KIT
6	11300086	1	13-10021	SAFETY SIGN OUTER GUARD
7	11300084	1	97-22532	OUTER GUARD
8	11300085	1	96-22532	INNER GUARD
9	11300087	1	13-10022	SAFETY SIGN INNER GUARD
10	11300080	1	98-22532	YOKE & SPLINE TUBE FEMALE
11	11300063	1	40-20021	BALL SHEAR ASSEMBLY
12	11300069	1	11-10044	LOCK NUT
13	11300068	1	11-10470	SHEAR BOLT
14	11300083	*	90-22532	GUARD SET OUTER + INNER
15	11300075	*	93-22532	HALF SHAFT MALE W/ SHIELD
16	11300076	*	95-22532	HALF SHAFT MALE W/O SHIELD
17	11300077	*	92-22532	HALF SHAFT FEMALE W/ SHIELD
18	11300078	*	94-22532	HALF SHAFT FEMALE W/O SHIELD



Agricultural Driveline Manufacturers Association

# OEM DRIVESHAFT DESIGN GUIDE TO ELIMINATE PTO ADAPTORS

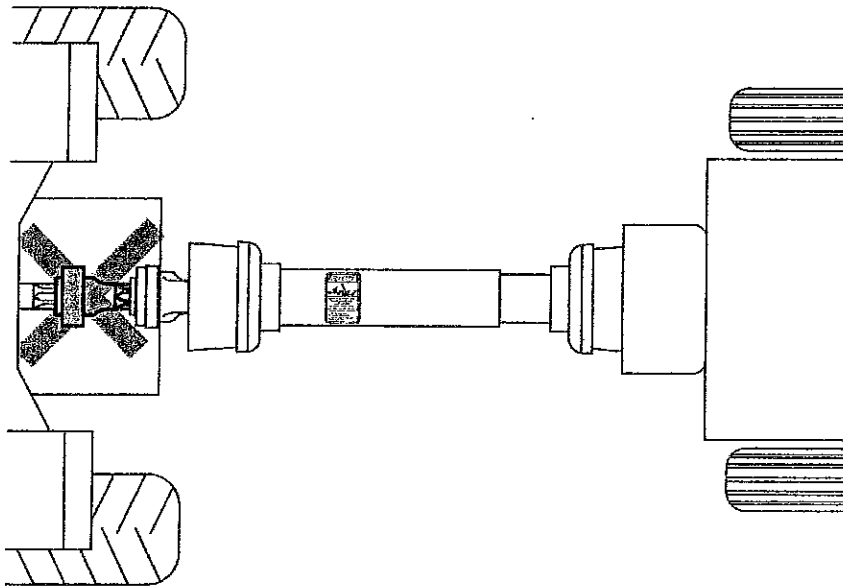

*Agriculture is recognized as one of the more hazardous occupations. Today's farmer spends long hours in close proximity to increasingly complex and powerful machinery. In order to avoid accidents, everyone from the component suppliers, to the company who manufactures and assembles the machinery, to the dealers and ultimately the actual user must keep safety in mind.*

*PTO adaptors have been used for many years to connect unmatched splines of tractor PTO shafts to implement PTO driveshafts. ADMA advises against the use of PTO adaptors which may defeat the purpose of the tractor's master shield and adversely affect the performance of the PTO driveshaft. International safety standards state, "No device (e.g. adaptors) shall be installed between the tractor PTO shaft and the primary PTO driveshaft."*

*ADMA is concerned that PTO driveshafts be used in the safest possible manner. This OEM Design Guide contains safety information directly related to the PTO driveshafts of agricultural implements. More information may be found in general safety literature and in the relevant standards published by the American Society of Agricultural and Biological Engineers (ASABE), the Canadian Standards Association (CSA), the International Standards Organization (ISO) and the Society of Automotive Engineers (SAE).*

## Registration Form – “400 Series” Power Ditchers

Please Return Promptly

Name: \_\_\_\_\_

Address: \_\_\_\_\_

City: \_\_\_\_\_ State: \_\_\_\_\_ Zip: \_\_\_\_\_

---

**Ditcher Style** ☐ Center Cut ☐ Offset Cut ☐ Disk

Model No. \_\_\_\_\_ (located on the Right-Hand side of the Drive Housing)

Serial No. \_\_\_\_\_ (located on the Right-Hand side of the Drive Housing)

**PTO Style** ☐ 1 3/8" Diameter – 6 Spline (540 rpm)

☐ 1 3/8" Diameter – 21 Spline (1000 rpm)

☐ 1 3/4" Diameter – 20 Spline (1000 rpm)

### Options

**Ripper** ☐ Yes

**Coulter** ☐ Yes

**Gage Wheel** ☐ Yes

---

### Dealer Purchased From

Name: \_\_\_\_\_

Address: \_\_\_\_\_

City: \_\_\_\_\_ State: \_\_\_\_\_ Zip: \_\_\_\_\_

---

### Mail To:

Remlinger Mfg. Co. Inc.  
P. O. Box 299  
Kalida, OH 45853

### Fax To:

(419) 532-2244

### Email To:

agsales@remlingermfg.com

**Thank you for purchasing the Remlinger Family of Products.**