

OWNER'S MANUAL)

Model: FSBK-13 (5300673)
(9-Nozzle Boom Assembly)

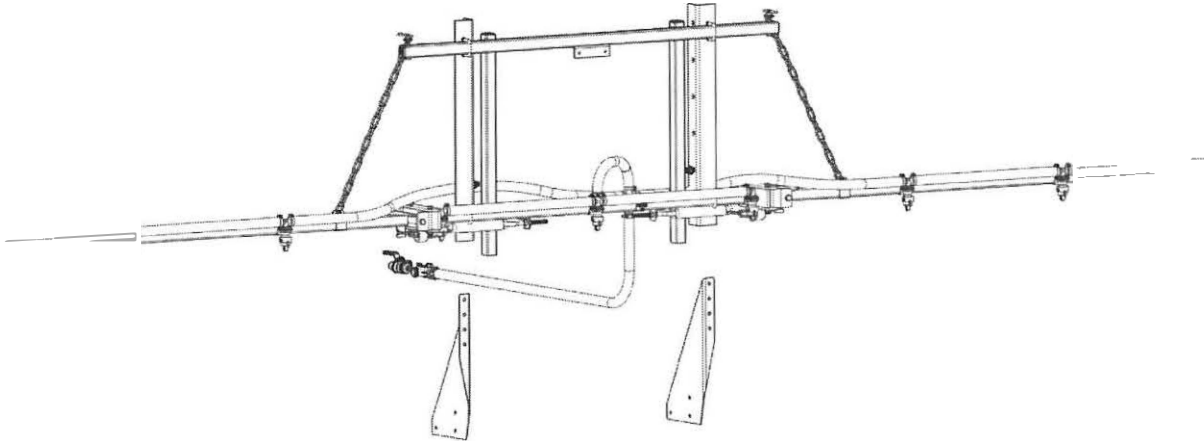

General Information

Thank you for purchasing this product. The purpose of this manual is to assist you in operating and maintaining your boom.



WARNING: To reduce the risk of injury, the user must read and understand the operator's manual before using this product.



WARNING: Cancer and Reproductive Harm.
www.P65Warnings.ca.gov

BAKERSFIELD, CA 877-724-2236	COLUMBUS, NE 800-274-1025	DOTHAN, AL 800-227-4098
FARGO, ND 701-280-2862	HOPKINSVILLE, KY 800-637-7172	MANKATO, MN 507-388-6295
NEWTON, KS 800-394-7662	PASCO, WA 800-634-2026	TEMPE, AZ 877-974-7166

If you should have a question or experience a problem with your Cimarron Product: Call the Toll free number above. Our technical support representatives will be happy to help you.

In most cases a customer service rep. can resolve the problem over the phone.

To obtain prompt, efficient service, always remember to give the following information....

- Correct Part Description and/or part number
- Model number and Serial Number

Part descriptions and numbers can be obtained from the illustrated parts list section(s) of this manual.

Retain a copy of your receipt for your unit, as it will be required to validate any warranty service.

Warranted against manufacturer or workmanship defects from date of purchase with copy of receipt:

Homeowner Usage: One Year

Commercial Usage: 90 Days.



Contents

Technical Specifications.....	2	Boom Exploded Views.....	5
Assembly Instructions.....	2 - 3	Nozzle Harness Exploded Views.....	6
Operation and Calibration.....	3 - 4	Parts List.....	7
Maintenance and Winter Storage.....	4	Warranty.....	8

Model: FSBK-13 (5300673)

(9-Nozzle Boom Assembly)

Technical Specifications

- 4-Row, 9-Nozzle Boom (15' Coverage)
 - Height Adjustment
 - 4-Way Hinge for Boom Protection
- Tips/Caps/Strainers are Standard (Tips: 'AIXR' series) (Air Induction eXtended Range)

This boom weighs approx. 50 Lbs.

Always check the vehicle load rating before using a boom with sprayer, ensuring total weight is acceptable.

Do not exceed the recommended rating.

IMPORTANT

It is VERY important to test the sprayer, after attaching any boom with plain water before actual spraying is attempted. This will enable you to familiarize yourself with the sprayer and check for leaks without the possibility of losing any expensive chemicals.

WARNING



Read and Understand the Owner's Manual before using this boom. Test and use in accordance to instructions. **Read and Follow** chemical label instructions and wear protective gear when filling, using, cleaning and servicing the boom.

Exercise Caution in vehicle handling when towing/hauling a filled sprayer to avoid loss of control or overturning.

Keep Sprayer and Spray materials away from other people, children and pets.

Do Not Turn on Power to the sprayer, until ready to spray in order to avoid unintentional spray release.

Do Not Use on steep slopes. A full sprayer could cause loss of control or overturn sprayer and vehicle.

Always operate up and down a slope, never across the face of a slope.

Keep all movement on slopes slow and gradual. Do not make sudden changes in speed, directions or turning. Do not start or stop suddenly when going uphill or downhill.

Stop on level ground, set the parking brake and shut off engine before leaving the operator's position for any reason.

Keep all parts in good condition and properly installed. Fix damaged or worn parts immediately.

Caution should be taken when towing and/or using any sprayer. The sprayer combined with the weight distribution, turning radius and speed of vehicle can result in damage to vehicle, sprayer and/or boom or severe injury or death, if not used properly.

Improper use or handling of chemicals could result in serious injury or illness, or could cause damage to the environment.

Assembly Instructions

Remove the parts to the boom assembly from carton. Refer to the parts list and exploded view drawing to help identify all the components.

1. Notice that (2) sets of boom mounting brackets are furnished. The angle mounts are to be used with 3 PT carriers and certain agricultural trailers. The left and right boom mount brackets are to be used with the 60 gallon skid mounted sprayers. Select the mounting brackets for your sprayer and attach them to your carrier using the bolts and nuts provided.
2. Use the (4) square u-bolts to attach the boom center frame to the boom mounting brackets. Set the lower tube member to be approx. 20" above the ground.
3. Attach the boom chains to the top tube of the center frame. The retainer bolts (with the chain) are placed into the holes at the ends of the top tube from beneath. See Boom Detail C.
4. Connect the outer boom sections to the boom center frame.
5. Thread a hex nut all the way onto each of the eyebolts. Insert an eyebolt through the hole in the vertical tube of the center frame. Start hex nut onto the end of each eyebolt.
6. Allow the outer end of the boom to go down to the ground by disconnecting the boom chain from the slide clamp. Hook a short chain (5 links) to the hook on the bottom side of the outer boom. Extend the chain through the tube on the lower hinge connector. Then join the chain and to the eyebolt with a 6" spring.

(Assembly Instructions Continued Next Page)

Assembly Instructions (Continued)

7. Lift the outer end of the outer boom and bolt the boom chain to the slide clamp. Thread the outer hex nut further onto the eyebolt to tighten the spring tension if necessary. Tighten the inner hex nut against the vertical tube to lock the eyebolt in place.
8. If the outer booms are not level or parallel with the ground, loosen the bolts in the slide clamps (located at the end of the chain) and slide in or out until outer boom is level. Retighten the hex screws.
9. Attach the harness assembly to the spray boom sections. Notice each section has 3 nozzles. Start at the center and mount the clamps (with nozzles) in place. Each nozzle should be located approximately 20" apart. Then center boom has "L" connectors on each end, whereas each outer boom has "L" connectors on the outer nozzle.
10. Connect the boom feeder lines to the individual boom sections. Use hose clamps to secure the hoses.
11. The outer booms may be secured in a raised position by slipping the "shortened" boom chains onto the retainer bolts and holding them with a flat washer and hair pin cotter.

Testing the Sprayer

NOTE: It is VERY important for you to test your sprayer with plain water before actual spraying is attempted. This will enable you to check for leaks without the possibility of losing any expensive chemicals.

Operation

Always fill the tank 1/2 full with water first and then add the chemical slowly, mixing as you pour the chemical into the tank and then fill the rest of the way. You may use your handgun or the bypass line in order to mix the chemical and water.

Initially begin spraying by opening the handgun/boom. This will enable the air in the line to be purged through the handgun tip/boom tip, while building pressure.

Adjusting Pressure

- When the bypass valve is closed, pressure is at the highest point.
- Opening the valve will decrease pressure.

Conditions of weather and terrain must be considered when setting the sprayer. Do not spray on windy days. Protective clothing must be worn in some cases

Be sure to read the chemical label(s) before application!

Calibration

Chemical labels may show application rates in gallons per acre, gallons per 1000 square feet or gallons per 100 square feet. You will note that the tip chart shows 2 of these rating systems.

Once you know how much you are going to spray, then determine (from the tip chart) the spraying pressure (PSI), and the spraying speed (MPH).

Determining the proper speed of the pulling vehicle can be done by marking off 100, 200 & 300 feet. The speed chart indicates the number of seconds it takes to travel the distances. Set the throttle and with a running start, travel the distances. Adjust the throttle until you travel the distances in the number of seconds indicated by the speed chart. Once you have reached the throttle setting needed, mark the throttle location so you can stop and go again, returning to the same speed.

After testing, add water and proper amount of chemical to the tank and drive to the starting place for spraying. Adjust the pressure and spray as you did in the testing procedure.

	Pressure (psi)	Capacity (GPM)	1 MPH	2 MPH	3 MPH	4 MPH	5 MPH	6 MPH	8 MPH	10 MPH
Gallons Per Acre Based on Water	15	.12	35.6	17.8	11.8	8.9	7.1	5.9	4.5	3.6
	20	.14	41.6	20.8	13.8	10.4	8.3	6.9	5.2	4.2
	30	.17	50.4	25.2	16.8	12.6	10.1	8.4	6.3	5.0
	40	.20	59.6	29.8	19.8	14.9	11.9	9.9	7.4	5.9
Gallons Per 1000 Sq. Ft. Based on Water	15	.12		.41	.27	.20	.16			
	20	.14		.48	.32	.24	.19			
	30	.17		.58	.39	.29	.23			
	40	.20		.68	.45	.34	.27			

Speed in M.P.H. (Miles Per Hour)	Time Required in seconds to travel a distance of		
	100 Ft.	200 Ft.	300 Ft.
1.0	68 sec.	136	205
2.0	34	68	102
3.0	23	45	68
4.0	17	34	51
5.0	14	27	41
6.0	11	23	34
7.0	9.7	19	29
8.0	8.5	17	26
9.0	7.6	15	23
10.0	6.8	14	20

Tip Selection

Important Note: The tips supplied as standard with this boom assembly are number AIXR11002VP tips, when you refer to the spray tip rate chart found in this owner's manual, you will note that they have a GPA range of 7.1 to 11.9 GPA (Gallons Per Acre). This is tabulated at 5 MPH and from 15-40 psi and 20" nozzle spacing. These rates are based on water. Please read this tip selection section carefully before attempting to operate your boom assembly.

The selection of proper tips for the boom is determined by the gallon per acre (GPA) requirement, which is specified on the chemical label. The following characteristics also have a determining factor and must be considered:

1. Speed of spraying (MPH)
2. Boom nozzle spacing (specified in inches)
3. Solution weight and conversion factor (CF)
4. Gallons of solution to be sprayed per acre
5. Spraying pressure

Useful Formulas:

GPM—Gallons Per Minute

GPA—Gallons Per Acre

MPH—Miles Per Hour

Using the Boom Nozzle

Four things must be considered before spraying with the boom.

1. How much chemical must be mixed in the tank.
 2. Rate of spray (gallons per acre to be sprayed).
 3. What pressure (p.s.i.) will be used.
 4. Speed traveled (mph) while spraying.
- * Refer to the chemical label to determine your chemical mixture
 - * See the tip chart to determine the pressure to be used. The chart will also show the speed used when spraying.
 - * Start the pump and open the valve to the boom nozzles.
 - * Check the spray pattern. Usually you can see the coverage better on a solid concrete surface, such as a driveway.

Maintenance During/After Spraying

After use, fill your sprayer tank part way with water. Start the sprayer and allow the clear water to be pumped through the plumbing system and out through the spray nozzles.

Refill the tank about half full with plain water and use FIMCO Tank Neutralizer and Cleaner and repeat cleaning instructions above. Flush the entire sprayer with the neutralizing/cleaning agent, then flush out one more time with plain water. Follow the chemical manufacturer's disposal instructions of all wash or rinsing water. For the boom, remove the tips and screens from the nozzle assemblies. Wash these items out thoroughly. Blow the orifice clean and dry. If the orifice remains clogged, clean it with a fine bristle (NOT WIRE) brush or with a toothpick. Do not damage the orifice. Water rinse and dry the tips before storing.

Winterizing your Sprayer

It is essential that you winterize your sprayer to avoid damage and to allow for optimal performance. The winterization process should be undertaken before freezing conditions and/or after each season of use.

Before storing your sprayer for winter or long term storage, thoroughly clean and drain it as much as possible. Then pour enough antifreeze into the tank so that when the pump is turned on you can pump the antifreeze throughout the entire plumbing system, including the bypass. Make sure to operate the boom and handgun until you see fluid spraying from the nozzles. Leave any remaining antifreeze in the tank. Before your next usage, rinse the antifreeze from the sprayer with clean water.

It is nearly impossible to drain all of the water from the sprayer and any trapped water can freeze in cold weather and damage parts of the sprayer. Pumping the antifreeze through the system will displace the water and help prevent this damage.

1. Verify that the tank is empty and rinsed out. Pour 1-2 gallons of antifreeze into the tank.
 - A. 12-Volt Pump, use pink RV Antifreeze through the system. This will keep internal parts lubricated, protect against corrosion and keep the unit from freezing.

Note: RV antifreeze is non-toxic, biodegradable and generally safer for the environment than automotive antifreeze.
 - B. Roller Pump, use a solution of automotive antifreeze (containing a rust inhibitor) through the entire plumbing system.
2. Engage the pump and spray with the boom and spray gun (if applicable). Make sure that the antifreeze has been pumped through the entire system, including all spray nozzles.
3. Before spraying in the spring, it is recommended to flush the sprayer with fresh water to cleanse it of the antifreeze and any other buildup. It would also be beneficial to do a thorough inspection of all sprayer components before spraying.

Removing from storage: drain the antifreeze. Fill the tank with fresh water and run through the system. Dispose of antifreeze and flush water properly.

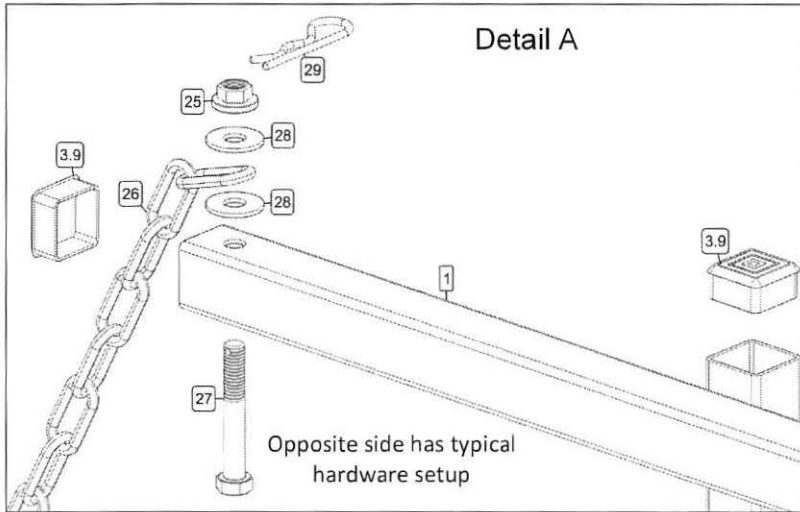

Exploded View: FSBK-13 (5300673)
(See Page 7 for Part Numbers)

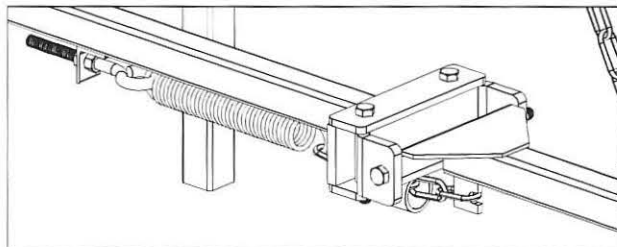
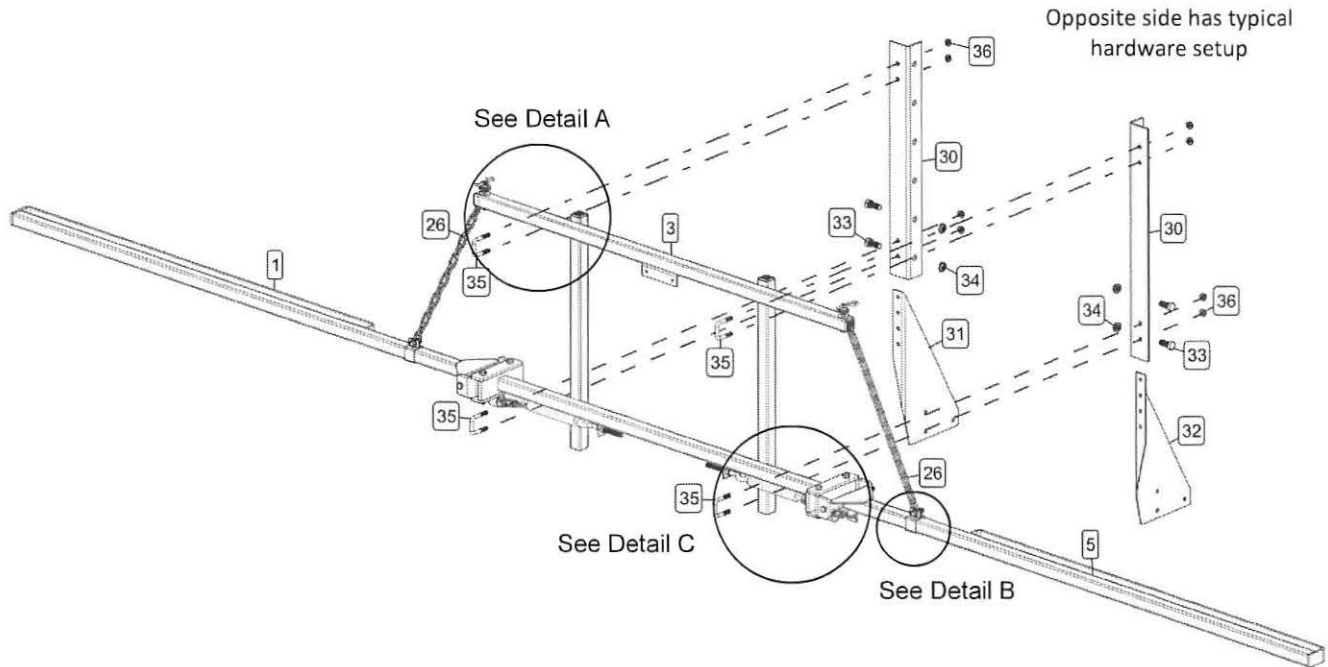
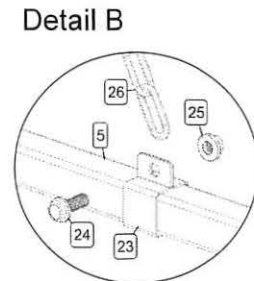

Opposite side has typical hardware setup

Detail C

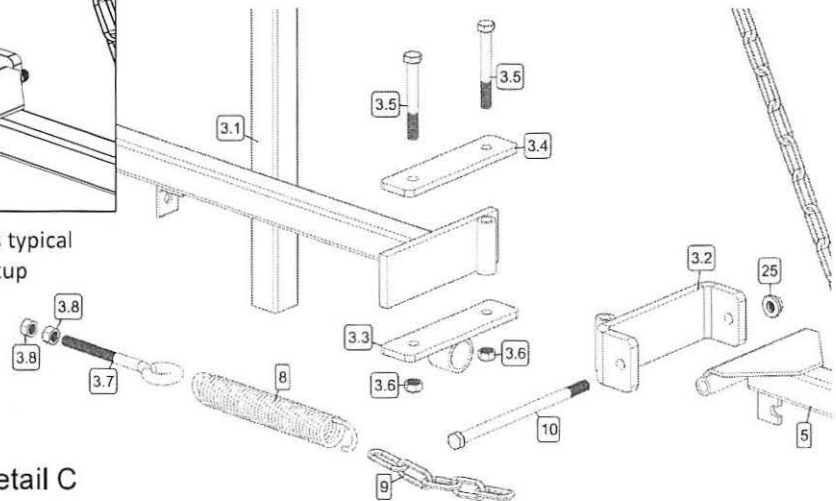

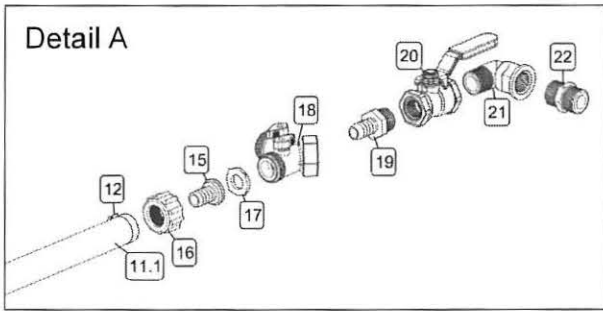

Exploded View: FSBK-13 (5300673)
Nozzle Harness Assemblies
& Feeder Hose Assembly
 (See Page 7 for Part Numbers)

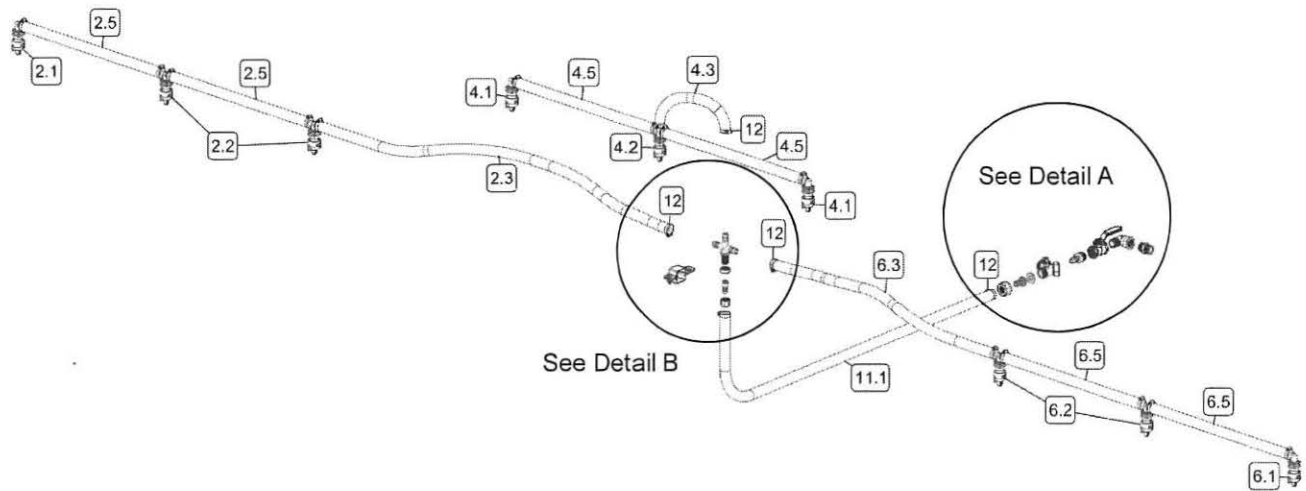
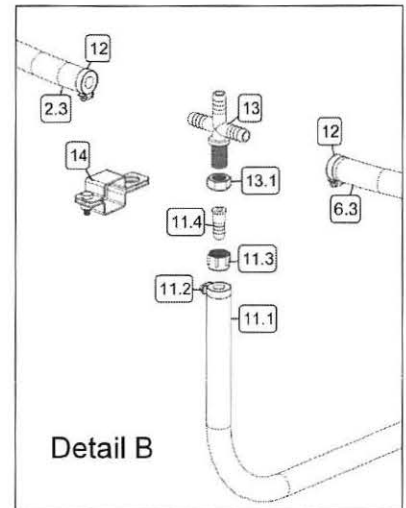

Nozzle Assemblies consist of "Elbow", "Tee" & "Cross" style nozzles.

Typical Nozzle Assembly Configurations are the same on each harness

Assemblies include: Nozzle Body, Strainer, Seat Washer, AIXR11003VP Nozzles & Nozzle Cap

CROSS Assembly	TEE Assembly	ELL Assembly
#5281315	#5281313	#5281311

Left & Right Nozzle Harnesses consist of one ELL Nozzle Assembly & two TEE Nozzle Assemblies.

Center Nozzle Harness consists of two ELL Nozzle Assemblies & one CROSS Nozzle Assembly

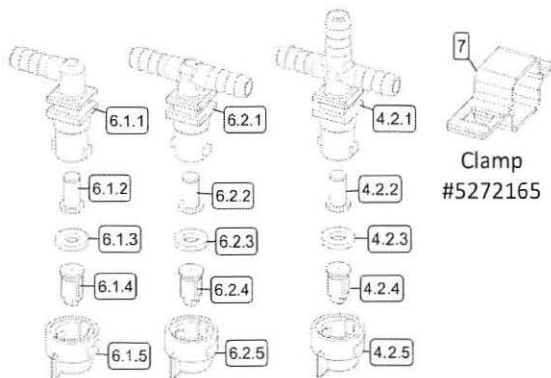

110° wide, tapered flat spray angle with air induction technology for better drift management. Made of 2-piece UHMWPE polymer construction which provides excellent chemical resistance, including acids, as well as exceptional wear life. Compact size to prevent tip damage. Removable pre-orifice. Excellent for systemic products and drift management.

When selecting pressure from the chart it is a good idea to try for the 20-30 PSI range as this allows an excellent nozzle pattern. At 10 PSI, the nozzle pattern starts to break up. At 40 PSI and above, the spray becomes very fine and this enhances drift.

Parts List: FSBK-13 (5300673)

Ref. #	Part #	Description	Qty
1	5272196-BLK	Outer Boom Weldment (L.H.)	1
2	5277878	(LH) Nozzle Harness	1
2.1	5281311	'ELL' Nozzle Assembly (3/8")	1
2.1.1	5056065	Single Hose Shank (1/2" Hose)	1
2.1.2	5143543	Check Valve Strainer, 50 Mesh, 5 PSI	1
2.1.3	5016157	Seat Washer (QJ Caps)	1
2.1.4	5018371	Air-Induction XR Flat Spray Tip (AIXR11002VP)	1
2.1.5	5046219	Quick TeeJet Cap ONLY (Yellow)	1
2.2	5281313	'TEE' Nozzle Assembly (3/8")	2
2.2.1	5056067	Double Hose Shank (1/2" Hose)	1
2.2.2	5143543	Check Valve Strainer, 50 Mesh, 5 PSI	1
2.2.3	5016157	Seat Washer (QJ Caps)	1
2.2.4	5018371	Air-Induction XR Flat Spray Tip (AIXR11002VP)	1
2.2.5	5046219	Quick TeeJet Cap ONLY (Yellow)	1
2.3	5020122	Hose, 1/2"-1 Brd. x 48"	1
2.4	5051114	Hose Clamp, 1/2"	5
2.5	5020416	Hose, 1/2"-1 Brd. x 19 3/8"	2
3	5273383	Boom Sub-Assembly (Center Section)	1
3.1	5272224-BLK	Center Frame Weldment	1
3.2	5272195-BLK	Hinge Clevis Weldment	2
3.3	5272194-BLK	Lower Hinge Connector Weldment	2
3.4	5080018-BLK	Hinge Connector	2
3.5	5034078	H.H.C.S. 3/8"-16nc x 3"	4
3.6	5006092	3/8"-16 Hex Locknut	4
3.7	5034107	3/8" x 4" Eyebolt, Turned, Zinc-Plated	2
3.8	5006054	3/8"-16 Hex Nut	4
3.9	5046344	Square Cap, Black (1 1/4" Square)	4
4	5277877	Center Nozzle Harness	1
4.1	5281311	'ELL' Nozzle Assembly (3/8")	2
4.1.1	5056065	Single Hose Shank (1/2" Hose)	1
4.1.2	5143543	Check Valve Strainer, 50 Mesh, 5 PSI	1
4.1.3	5016157	Seat Washer (QJ Caps)	1
4.1.4	5018371	Air-Induction XR Flat Spray Tip (AIXR11002VP)	1
4.1.5	5046219	Quick TeeJet Cap ONLY (Yellow)	1
4.2	5281315	'CROSS' Nozzle Assembly (3/8")	1
4.2.1	5056069	Triple Hose Shank (1/2" Hose)	1
4.2.2	5143543	Check Valve Strainer, 50 Mesh, 5 PSI	1
4.2.3	5016157	Seat Washer (QJ Caps)	1
4.2.4	5018371	Air-Induction XR Flat Spray Tip (AIXR11002VP)	1
4.2.5	5046219	Quick TeeJet Cap ONLY (Yellow)	1
4.3	5020176	Hose, 1/2"-1 Brd. x 12"	1
4.4	5051114	Hose Clamp (3/8"-1/2")	5
4.5	5020416	Hose, 1/2"-1 Brd. x 19 3/8"	2
5	5272242-BLK	Outer Boom Weldment (R.H.)	1
6	5277879	(RH) Nozzle Harness	1
6.1	5281311	'ELL' Nozzle Assembly (3/8")	1
6.1.1	5056065	Single Hose Shank (1/2" Hose)	1
6.1.2	5143543	Check Valve Strainer, 50 Mesh, 5 PSI	1

Ref. #	Part #	Description	Qty
6.1.3	5016157	Seat Washer (QJ Caps)	1
6.1.4	5018371	Air-Induction XR Flat Spray Tip (AIXR11002VP)	1
6.1.5	5046219	Quick TeeJet Cap ONLY (Yellow)	1
6.2	5281313	'TEE' Nozzle Assembly (3/8")	1
6.2.1	5056067	Double Hose Shank (1/2" Hose)	1
6.2.2	5143543	Check Valve Strainer, 50 Mesh, 5 PSI	1
6.2.3	5016157	Seat Washer (QJ Caps)	1
6.2.4	5018371	Air-Induction XR Flat Spray Tip (AIXR11002VP)	1
6.2.5	5046219	Quick TeeJet Cap ONLY (Yellow)	1
6.3	5020122	Hose, 1/2"-1 Brd. x 48"	1
6.4	5051114	Hose Clamp (3/8"-1/2")	5
6.5	5020416	Hose, 1/2"-1 Brd. x 19 3/8"	2
7	5272165	Vari-Quick Clamp (1 1/4" Sq. Tube)	9
8	5019142	Turf Spring, 6"	2
9	5049031	Spring Chain (5 Links)	2
10	5034187	H.H.C.S., 3/8"-16 x 7"	2
11	5273387	Feeder Hose Assembly	1
11.1	5020121	Hose, 1/2"-1 Brd. x 9 Ft.	1
11.2	5051114	Hose Clamp (3/8"-1/2")	1
11.3	5046126	Poly Nozzle Cap, 11/16" U.N.F. Thread	1
11.4	5149040	Poly Swivel Barb (for 1/2" I.D. Hose)	1
12	5051114	Hose Clamp (3/8"-1/2")	4
13	5056093	Poly Cross Fitting, 11/16" MPS x 1/2" HB	1
13.1	5006212	11/16" FPS Nozzle Body Lock Nut	1
14	5273796	1 1/4" Square Boom Nozzle Clamp	1
15	5149035	Poly Swivel, 1/2" Hose Barb	1
16	5006209	Poly Knurled Swivel Nut, 3/4" FGHT	1
17	5016066	Garden Hose Washer	1
18	5143204	Dual Hose Shut-Off "Y" Valve	1
19	5067131	Poly Fitting, 1/2" MNPT x 1/2" HB	1
20	5143197	1/2" T-800 Brass Ball Valve	1
21	5010243	Poly Street Elbow, (90°) 1/2" MNPT x 1/2" FNPT	1
22	5011139	Poly Close Nipple, 1/2" MNPT	1
23	5051085-BLK	Slide Clamp	2
24	5117307	3/8"-16 x 1" Whiz (Flange) Lockscrew	2
25	5006259	3/8"-16 Hex Whiz (Flange) Locknut	6
26	5049034	Boom Chain (16 Links)	2
27	5034186	H.H.C.S., 3/8"-16 x 2 1/2" (Grade 2)	2
28	5016030	Flatwasher, 3/8"	4
29	5101065	#211 Hitch Pin Clip (Zinc Plated)	2
30	5022199-BLK	Angle Upright Mount	2
31	5038671-BLK	Boom Mount Bracket (L.H.)	1
32	5038672-BLK	Boom Mount Bracket (R.H.)	1
33	5034019	H.H.C.S. 1/2"-13nc x 1 1/4"	4
34	5006337	1/2"-13 Hex Whiz (Flange) Locknut	4
35	5034159	Square U-Bolt, 5/16" x 1 5/16" x 1 7/8"	4
36	5006307	5/16"-18 Hex Whiz (Flange) Locknut	8

Warranty

LIMITED WARRANTY FOR NEW Cimarron EQUIPMENT

WHO MAY USE THIS LIMITED WARRANTY. This limited warranty (the "Limited Warranty") is provided by Cimarron Equipment to the original purchaser ("you") of the Equipment (as defined below) from Cimarron Equipment or one of Cimarron Equipment's authorized dealers. This Limited Warranty does not apply to any subsequent owner or other transferee of the Equipment. THIS LIMITED WARRANTY GIVES YOU SPECIFIC LEGAL RIGHTS, AND YOU MAY ALSO HAVE OTHER RIGHTS WHICH VARY FROM STATE TO STATE.

WHAT THIS LIMITED WARRANTY COVERS AND FOR HOW LONG. Cimarron Equipment warrants that any new Equipment will be free from defects in material and workmanship for a period of **one (1) year** after delivery of the Equipment to you (the "Warranty Period"). The Warranty Period is not extended if Cimarron Equipment repairs or replaces the Equipment.

WHAT IS NOT COVERED BY THIS LIMITED WARRANTY. This Limited Warranty does not apply to: (1) used Equipment; (2) any Equipment that has been altered, changed, repaired or treated since its delivery to you, other than by Cimarron Equipment or its authorized dealers; (3) damage or depreciation due to normal wear and tear; (4) defects or damage due to failure to follow Cimarron Equipment's operator's manual, specifications or other written instructions, or improper storage, operation, maintenance, application or installation of parts; (5) defects or damage due to mis-use, accident or neglect, "acts of God" or other events beyond Cimarron Equipment's reasonable control; (6) accessories, attachments, tools or parts that were not manufactured by Cimarron Equipment, whether or not sold or operated with the Equipment; or (7) rubber parts, such as tires, hoses and grommets.

HOW TO OBTAIN WARRANTY SERVICE. To obtain warranty service under this Limited Warranty, you must (1) provide written notice to Cimarron Equipment of the defect during the Warranty Period and within **thirty (30) days** after the defect becomes apparent or the repair becomes necessary, at the following address: Cimarron Equipment, 1000 Fimco Lane, North Sioux City, SD 57049; and (2) make the Equipment available to Cimarron Equipment or an authorized dealer within a reasonable period of time. For more information about this Limited Warranty, please call: **800-274-1025** or your local Cimarron location.

WHAT REMEDIES ARE AVAILABLE UNDER THIS LIMITED WARRANTY. If the conditions set forth above are fulfilled and the Equipment or any part thereof is found to be defective, Cimarron Equipment shall, at its own cost, and at its option, either repair or replace the defective Equipment or part. Cimarron Equipment will pay for shipping and handling fees to return the repaired or replacement Equipment or part to you.

LIMITATION OF IMPLIED WARRANTIES AND OTHER REMEDIES. THE REMEDIES DESCRIBED ABOVE ARE YOUR SOLE AND EXCLUSIVE REMEDIES, AND Cimarron EQUIPMENT'S SOLE LIABILITY, FOR ANY BREACH OF THIS LIMITED WARRANTY. TO THE EXTENT APPLICABLE, ANY IMPLIED WARRANTIES, INCLUDING, WITHOUT LIMITATION, THE IMPLIED WARRANTIES OF MERCHANTABILITY AND FITNESS FOR A PARTICULAR PURPOSE, SHALL BE LIMITED IN DURATION TO THE WARRANTY PERIOD, AND THE REMEDIES AVAILABLE FOR BREACH THEREOF SHALL BE LIMITED TO THE REMEDIES AVAILABLE UNDER THIS EXPRESS LIMITED WARRANTY. SOME STATES DO NOT ALLOW LIMITATIONS ON HOW LONG AN IMPLIED WARRANTY LASTS, SO THE ABOVE LIMITATION MAY NOT APPLY TO YOU. IN NO EVENT SHALL Cimarron EQUIPMENT'S LIABILITY UNDER THIS LIMITED WARRANTY EXCEED THE ACTUAL AMOUNT PAID BY YOU FOR THE DEFECTIVE EQUIPMENT, NOR SHALL Cimarron EQUIPMENT BE LIABLE, UNDER ANY CIRCUMSTANCES, FOR ANY CONSEQUENTIAL, INCIDENTAL, SPECIAL OR PUNITIVE DAMAGES OR LOSSES, WHETHER DIRECT OR INDIRECT. SOME STATES DO NOT ALLOW THE EXCLUSION OR LIMITATION OF INCIDENTAL OR CONSEQUENTIAL DAMAGES, SO THE ABOVE LIMITATION OR EXCLUSION MAY NOT APPLY TO YOU.